

Important tips for installation:

While connecting a new control unit (H+hwifi controller) to the heating element, one should pay special attention. These two parts should not be connected by force, without thinking. One needs to find and feel the right connecting position in order that the pins are correctly in line and next push the controller to the limit onto its heating element. It is not hard to do, but very important. When it is done, one should block the controller with the screw on the rear side, using the included allen key.

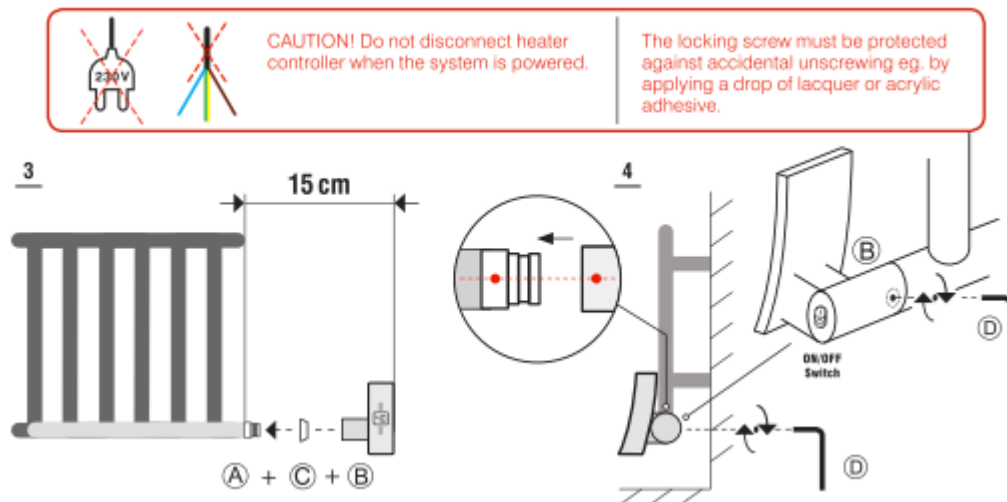

Whilst connecting (or detaching), the controller must NOT be connected to the mains!!

DO NOT DISCONNECT!
controller from heating element, when connected to the power supply

You can turn on the power once those two parts are connected one with another.

Installing the heating element into a radiator, the silicon spacer must be left in its place. It ensures a distance is maintained between the capillary tube and the heating rod.



Pay attention to the red dot which helps set the element in the right position.

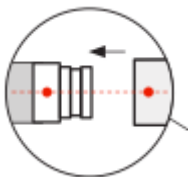

Do not fill the radiator with a special liquid. We recommended pure water or water / glycol mixture (preferably 80% + 20%).